

CMT ORANGE TOOLS™

EXPLODED DIAGRAM

999.110.00

PROFESIONAL ROUTER TABLE SYSTEM

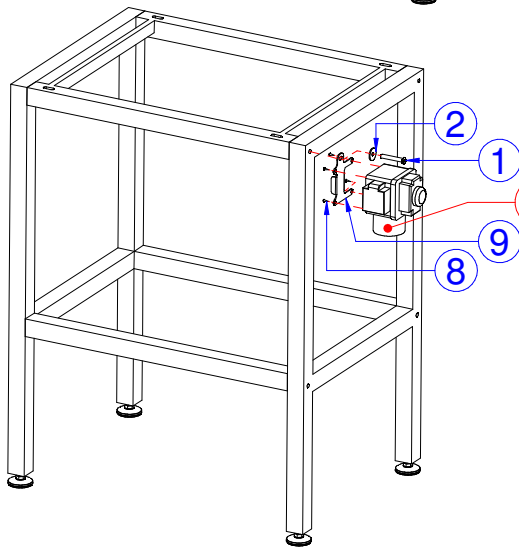
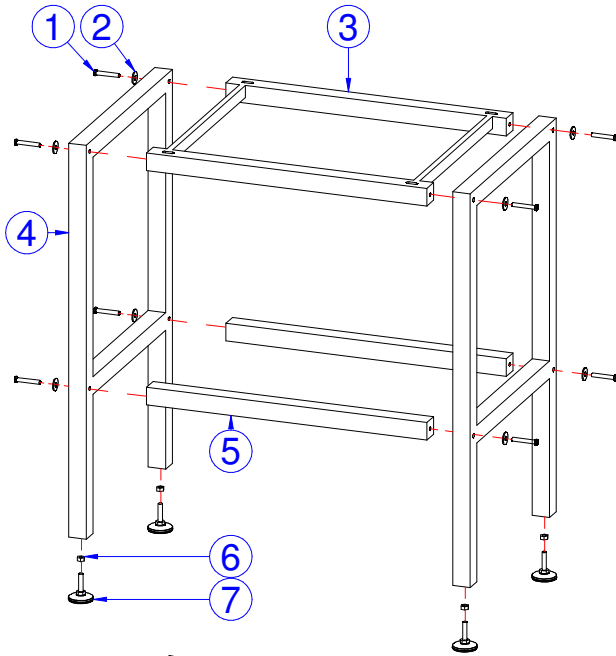

12 999.100.11 NOT INCLUDED in the box, but OBLIGATORY.

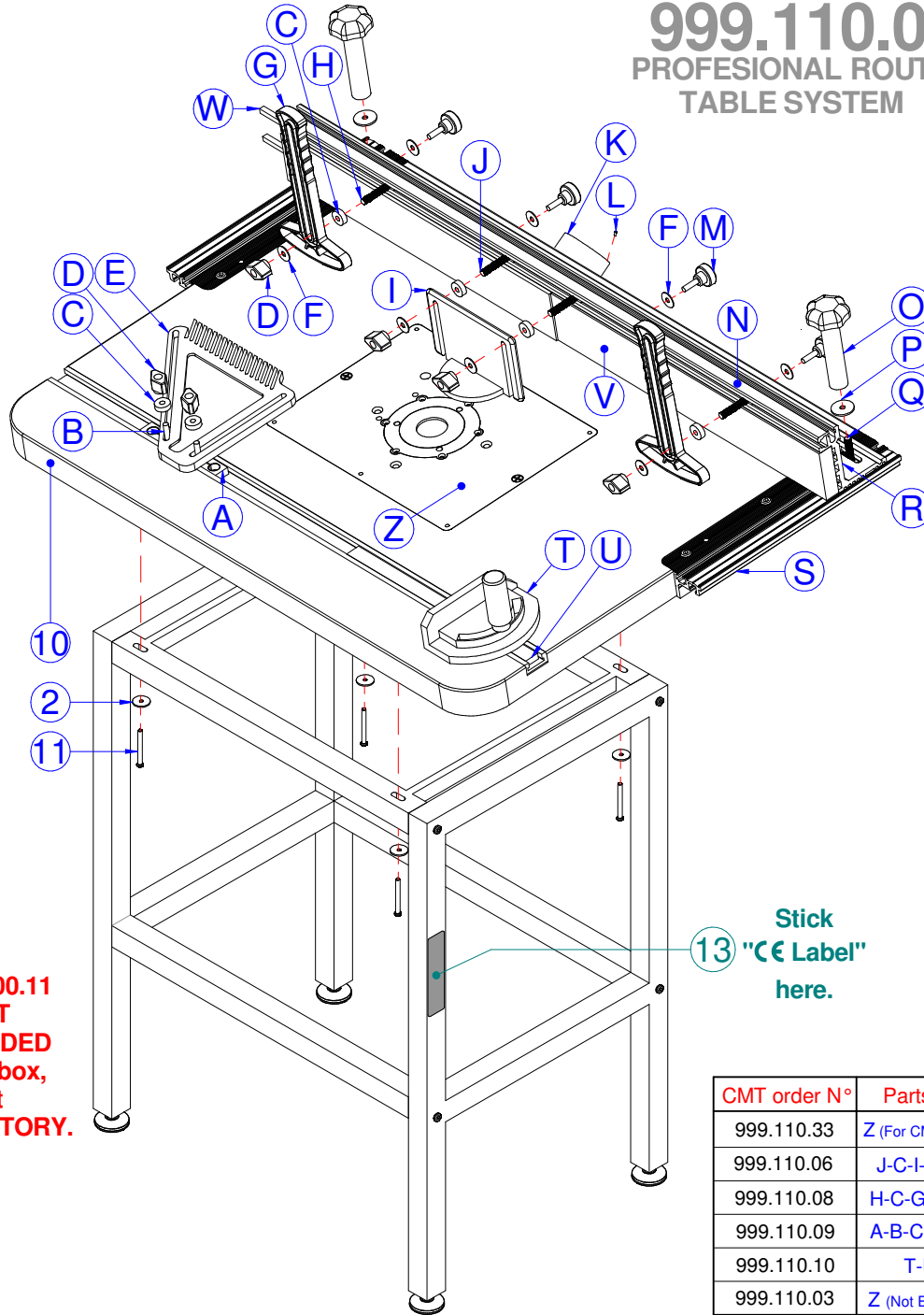

Stick "CE Label" here.

CMT order N°	Parts N°
999.110.33	Z (For CMT7E)
999.110.06	J-C-I-F-D
999.110.08	H-C-G-F-D
999.110.09	A-B-C-D-E
999.110.10	T-U
999.110.03	Z (Not Bored)

N°	Part Description	Q.ty
1	1/4"x2" Screw-BK	8
2	1/4"x28 Washer-BK	12
3	Top Frame	1
4	Legs	2
5	Crossbar	2
6	5/16" Nut	4
7	Plug	4
8	M5x15 Screw	4
9	Switch Bracket	1
10	Table Top	1
11	1/4"x1-3/4" Screw-BK	4
12	Electric Safety Switch	N.I.
13	CE Label	1
A	Slider	2
B	1/4"x1-9/16" Screw BK	2
C	PVC Washer 5mm	6
D	1/4" Rhombic Knob	6
E	Feather Board	1
F	1/4"x19 Washer	8
G	Holddown Board	2
H	1/4"x1-1/2" T Bolt	2
I	Safety Shield	1
J	1/4"x1-1/4" T Bolt	2
K	Dust Hood	1
L	M4x8 Screw-BK	1
M	1/4" Round Knob	4
N	Measuring Tape	1
O	Back Fence Knob	2
P	5/16"x25 Washer	2
Q	5/16"x1 T Bolt	2
R	Fence	1
S	T-track	RH 1 LH 1
T	Mitter Gauge	1
U	Mitter Gauge T-track	1
V	Wooden Fence Parts	2
W	Aluminum Shim Bar	2
Z	CMT7E Plate	1

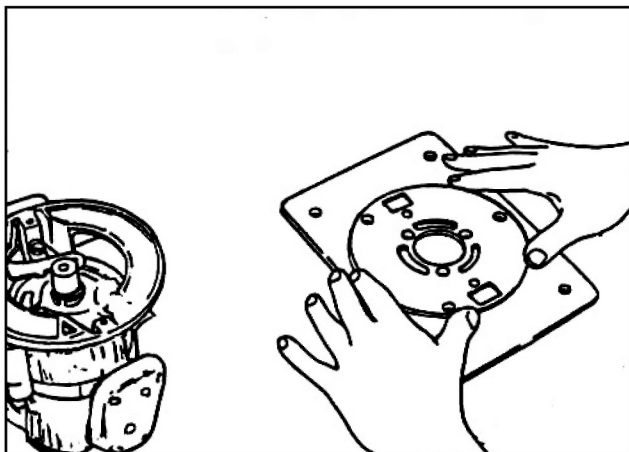

Fig. 1 Remove the base plate from the router (Make sure power is disconnected prior to installing router or removing base plate) and align the table plate hole to the router base plate hole.

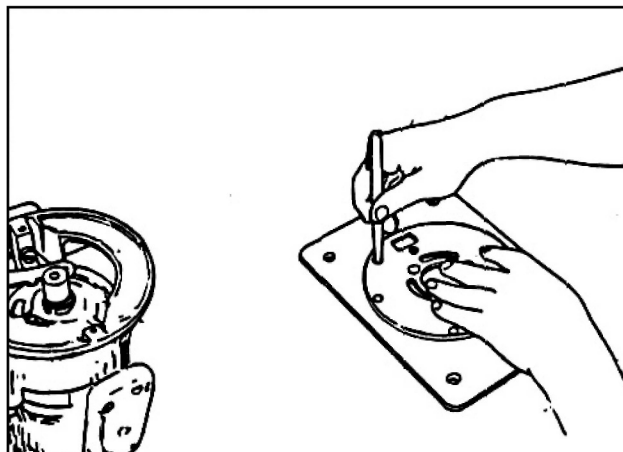

Fig.2 Use router base plate as a template to mark the location of each mounting hole onto the table plate.

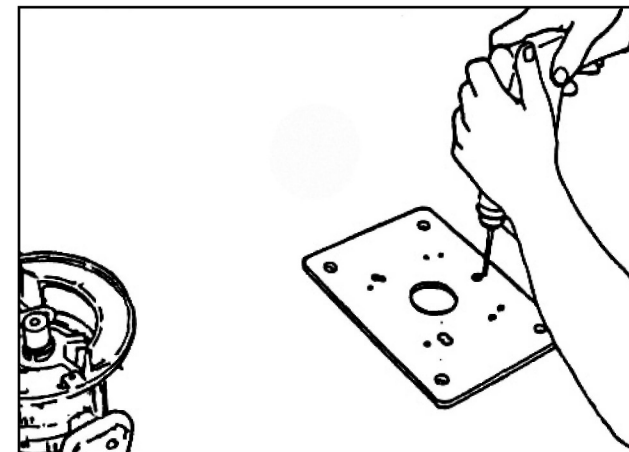

Fig.3 Drill mounting holes into the table plate and countersink or counter bore the top side of table plate so the head mounting screws are slightly below its surface.

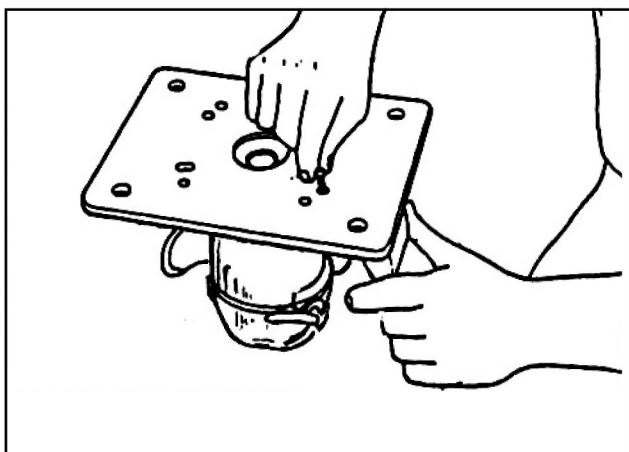

Fig. 4 Attach table plate to router using the proper mounting screws for your machine (not included.)

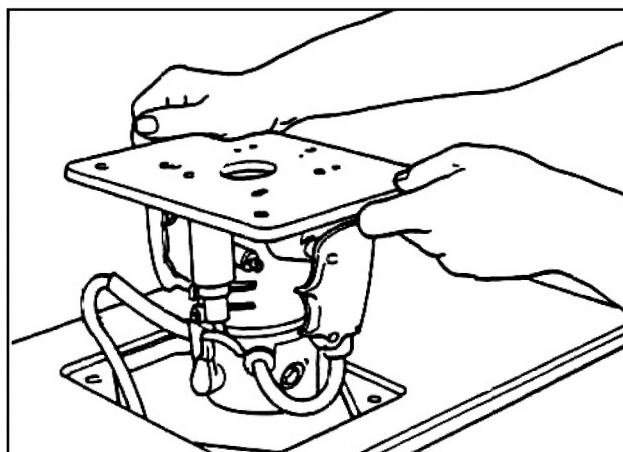

Fig.5 After setting the desired router bit and adjusting its height, lower router into the table opening.

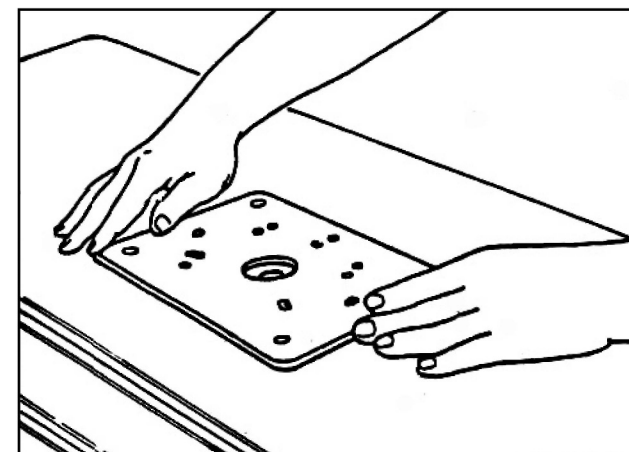

Fig.6 Make sure table plate is properly set into the table opening. The top of the table plate should be flush with the top of the table.